

Hi-Q Components

Hi-Q Electronics Ltd, PO Box 302 015, North Harbour, Auckland, New Zealand Ph + 64 9 415 3333 Fax + 64 9 415 8686

54-32S4120

PCB Mount - **Dia. 14.0mm**



Waterproof

Sound Pressure :80db/ 6vDC /10cm
Oscillating Freq. : 4.0 ± 0.5 KHz
Max Rated Current : 7 mA /12v DC
Operating Voltage : 3v to 16v DC
Pin Spacing : 7.6 mm

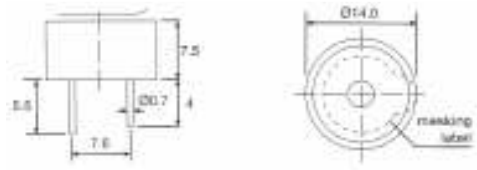

54-15210

PCB Mount - **Dia. 13.8mm**



Waterproof

Sound Pressure :85db/ 9vDC /10cm
Oscillating Freq. : 4.4 ± 0.5 KHz
Current Consumption : 8 mA / 9v DC
Operating Voltage : 3v to 15v DC
Pin Spacing : 7.6 mm

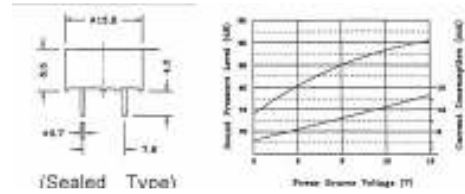

54-20C115

PCB Mount - **Dia. 24mm**



Sound Pressure :90db/9vDC /30cm
Oscillating Freq. : 3.4 ± 0.5 KHz
Current Consumption : 7mA/ max/9v DC
Operating Voltage : 3v to 15v DC
Pin Spacing : 15mm

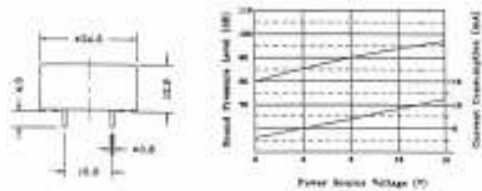

54-20C6

Lead Wire - **Dia. 24mm**



Sound Pressure :80db/9vDC /30cm
Oscillating Freq. : 3.4 ± 0.5 KHz
Current Consumption : 8mA max/9v DC
Operating Voltage : 3v to 30v DC
Lead Length : 135 ± 5 mm

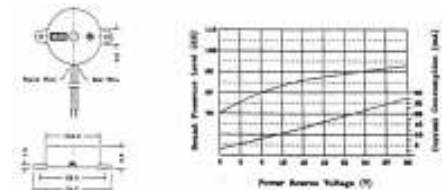

54-27C4

Lead Wire - **Dia. 30mm**



Sound Pressure :85db/9vDC/30cm
Oscillating Freq. : 3.5 ± 0.5 KHz
Current Consumption : 8mA max/9v DC
Operating Voltage : 3v to 30v DC
Lead Length : 75 ± 5 mm

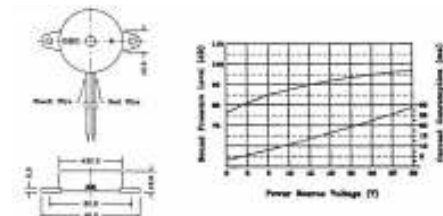

54-35 Series

Lead Wire - **Dia. 42mm**



Part No:

54-35C1
Continuous
Tone

54-35C2
Continuous
Tone

54-35D1
Dual Tone

54-35P2
Pulsating Tone

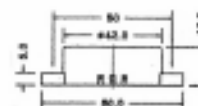
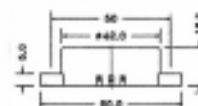
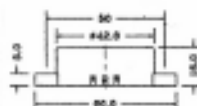
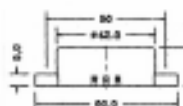

Lead Wires 120 ± 5 mm

Sound Pressure: :	88db / 9vDC / 30cm	97db / 9vDC / 30cm	97db / 9vDC / 30cm	93db / 6vDC / 30cm
Oscillating Frequency:	2.8 ± 0.5 KHz	2.8 ± 0.5 KHz	About 2.9/3.05 KHz	2.6 ± 0.5 KHz
Current Consumption:	8 mA max/9v DC	12mA max/9v DC	20mA max/9v DC	12mA max/9v DC
Operating Voltage:	3v to 30v DC	3v to 20v DC	5v to 20v DC	5v to 20v DC
Operating Temp. Range:	-20 °C to +60°C	-20 °C to +60°C	-20 °C to +60°C	-20 °C to +60°C

Panel Mount (Internal Drive)



54-7S4120



12A Series

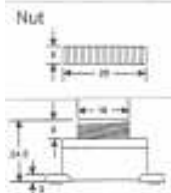
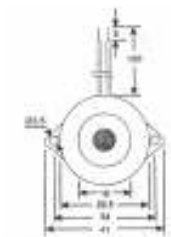

54-7S4120
Single Tone

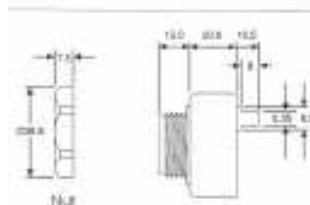
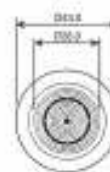

54-12AS3120
Single Tone

54-12ADN3120
Single / Slow Pulse

Minimum Sound Output: :	95dBA / 12vDC / 30cm	80dBA / 12vDC / 30cm	80dBA / 12vDC / 30cm
Oscillating Frequency:	3.5KHz \pm 0.5KHz	2.9KHz \pm 0.5KHz	2.9KHz \pm 0.5KHz
Operating Voltage:	1.5v to 16v DC	6v to 28v DC	6v to 28v DC
Rated Voltage:	12v DC	12v DC	12v DC
Rated Current:	15 mA max / 12v DC	20 mA max / 12v DC	20 mA max / 12v DC
Pulse Rate at 12VDC	Continuous	Continuous	1.2 \pm 20% Hz
Operating Temp. Range:	-20 °C to +60°C	-20 °C to +60°C	-20 °C to +60°C