

# Hi-Q Components

Hi-Q Electronics Ltd, PO Box 302 015, North Harbour, Auckland, New Zealand Ph + 64 9 415 3333 Fax + 64 9 415 8686

## Panel Mount Membrane Switches Schurter MCS 18 Series

- ★ Front panel sealed to IP 65 with 'O' ring kit and screw / bracket assembly.
- ★ Positive tactile feel with snap dome.
- ★ Available in 9 colours.
- ★ Bezel removable to insert key ident. film.

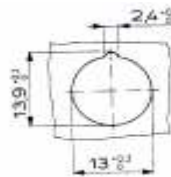

Front panel drilling



IP65 Seal Kit (O-ring,clip & screw)  
Part No. 41-0098.9201

### Specifications:

Contact Resistance : New < 50 mΩ After 10<sup>6</sup>cycles < 150 mΩ  
Switching Voltage : Silver Contact - Min . 5V DC Max. 48V DC  
Switching Current Max. : Silver 125 mA  
Insulation Resistance (pin to pin, off position) : >100 MΩ  
Contact Travel : 0.5 ± 0.1mm  
Lifetime (IEC512-5 Test 9a) : >1,000,000 operations  
Ambient Temperature : -25 °C to +60 °C .

Part Number	Part Number
Square Black Bezel/ Colour Face	Round Black Bezel/Colour Face
41-1100.791 - Yellow	41-1104.791 - Yellow
41-1100.793 - Red	41-1104.793 - Red
41-1100.795 - Green	41-1104.795 - Green
41-1100.796 - Grey	41-1104.796 - Grey
41-1100.797 - Black	41-1104.797 - Black
41-1100.798 - White	41-1104.798 - White

## Panel Mount Metallic Switches Schurter MCS 19 Series

- ★ Excellent tactile feedback.
- ★ Low profile of 1mm on front panel.
- ★ Protection IP65. – Panel Sealing to IP40.
- ★ Robust metal housing and vandal resistant.
- ★ Easy mounting with M19 nut and sealing ring.

The MCS 19 Metallic is designed for use in front panels or complete enclosures. The switch has mechanical end stop strength, so that the actuator cannot damage the contact element even when hit with hard strokes. The fastening is by a screwed joint and a nut (M19x0.75).. The actuator can be zinc diecasting nickel plated or stainless steel. The stainless steel version can be laser-lettered.



Std with Solder Aid with Clip



### Specifications:

Contact Resistance : New < 50 mΩ After 10<sup>6</sup> cycles < 150 mΩ  
Switching Voltage : Gold: Min. 50mV DC Max. 24VDC  
Silver: Min. 4VDC Max. 48VDC  
Switching Current Max. : Gold: 80 mA Silver: 125mA  
Rated breaking capacity. : Gold: 12V/30mA Silver: 24V/50mA  
Actuating Force : 3.7 N Contact Travel : 0.4 mm  
Lifetime (at rated breaking capacity) : >1,000,000 operations  
Ambient Temperature : -25 °C to +60 °C .

### Applications

Entry control systems - Door bell equipment - Vending machines -POS  
Info terminals - Car wash facilities - Elevator systems - Test equipment

Variant	Part Number Without Legend		Part Number With Legend	
	Silver	Gold	Silver	Gold
Standard terminals	41-1241.2800	41-1241.2810	41-1241.2805.xxx	41-1241.2815.xxx
With solder aid	41-1241.2801		41-1241.2806.xxx	
With Clip	41-1241.2802	41-1241.2812	41-1241.2807.xxx	41-1241.2817.xxx