

4122 – Male Anti-Vibration Mount

- ★ Rubber & Zinc plated Steel
- ★ * Cp Maximum load compression (kg)
- ★ * Cz Maximum load shear (Kg)

Part Number	D	h	E	d	s	Cp	Cz
11-AVM1515S4-12	15	15	12	M4	1.5	20	4
11-AVM2015S6-15	20	15	15	M6	1.5	50	4
11-AVM2020S6-15	20	20	15	M6	1.5	40	3
11-AVM2520S6-18	25	20	18	M6	2	60	6
11-AVM2530S6-18	25	30	18	M6	2	40	4
11-AVM3020S8-23	30	20	23	M8	2	90	10
11-AVM3030S8-23	30	30	23	M8	2	80	8
11-AVM3038S8-23	30	38	23	M8	2	65	6
11-AVM4030S8-23	40	30	23	M8	2	120	16
11-AVM4035S8-23	40	35	23	M8	2	100	14
11-AVM5020S10-27	50	20	27	M10	3	220	22
11-AVM5030S10-27	50	30	27	M10	3	200	20
11-AVM5040S10-27	50	40	27	M10	3	170	18
11-AVM5050S10-27	50	50	27	M10	3	150	14
11-AVM6550S12-37	65	50	37	M12	2	350	30
11-AVM7525S12-37	75	25	37	M12	3	500	90
11-AVM7540S12-37	75	40	37	M12	3	490	80
11-AVM7550S12-27	75	50	37	M12	3	480	70
11-AVM10050S16-46	100	50	46	M16	3	850	100
11-AVM10055S16-46	100	55	46	M16	4	800	80
11-AVM10060S16-46	100	60	46	M16	4	700	50

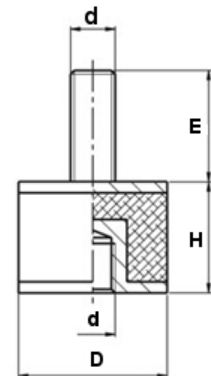

4123 – Female Anti-Vibration Mount

- ★ Rubber & Zinc plated Steel
- ★ * Cp Maximum load compression (kg)
- ★ * Cz Maximum load shear (Kg)

Part Number	D	h	d	s	Cp	Cz
11-AVF1515S4	15	15	M4	1.5	20	4
11-AVF2020S6	20	20	M6	1.5	40	3
11-AVF2520S6	25	20	M6	2	60	6
11-AVF2530S6	25	30	M6	2	40	4
11-AVF3020S8	30	20	M8	2	90	10
11-AVF3030S8	30	30	M8	2	80	8
11-AVF3038S8	30	38	M8	2	65	6
11-AVF4030S8	40	30	M8	2	120	16
11-AVF4035S8	40	35	M8	2	100	14
11-AVF5030S10	50	30	M10	3	200	20
11-AVF5040S10	50	40	M10	3	170	18
11-AVF5050S10	50	50	M10	3	150	14
11-AVF6550S10	65	50	M12	2	350	30
11-AVF7525S12	75	25	M12	3	500	90
11-AVF7540S12	75	40	M12	3	490	80
11-AVF7550S12	75	50	M12	3	480	70
11-AVF10050S16	100	50	M16	3	850	100
11-AVF10055S16	100	55	M16	4	800	80
11-AVF10060S16	100	60	M16	4	700	50

