

Anchor Rivets

- ★ Anchor Rivets provide versatile, inexpensive, corrosion & vibration resistant blind fasteners for solid or hollow materials including wood, concrete, plaster, metal or plastic
- ★ Installation is fast, rivet is inserted in predrilled hole and tapped with a hammer
The drive pin expands and secures the rivet
- ★ Typical uses include signs, liner panels, rails, floor plates, electrical and plumbing fixtures, conduit and piping

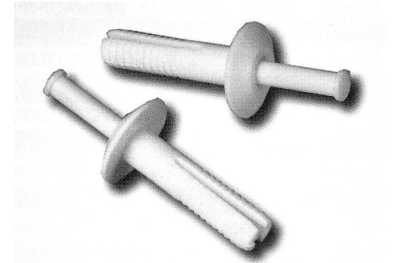

Also available with
Zinc Plated Steel Drive Pin.

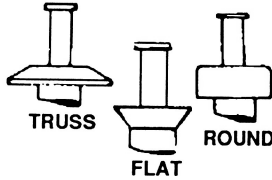
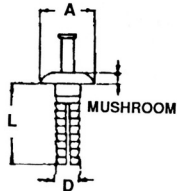
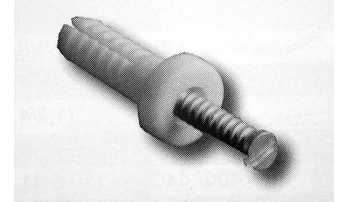

Part Number	Head Style	Shaft Dia. D	Length L	Head Dia. A	Head Height
04-APM48191	Mushroom	4.8	19.1	14.3	2.8
04-APM64191	Mushroom	6.4	19.1	14.3	2.8
04-APM64254	Mushroom	6.4	25.4	14.3	2.8
04-APM64381	Mushroom	6.4	38.1	14.3	2.8
04-APF64143	C/sink / Flat	6.4	14.3	11.1	2.7
04-APF64191	C/sink / Flat	6.4	19.1	11.1	2.7
04-APT48191	Truss	4.8	19.1	15.9	2.8
04-APT64191	Truss	6.4	19.1	15.9	2.8
04-APT64254	Truss	6.4	25.4	15.9	2.8
04-APT64381	Truss	6.4	38.1	15.9	2.8
04-APT64508	Truss	6.4	50.8	15.9	2.8
04-APT64762	Truss	6.4	76.2	15.9	2.8
04-APT641016	Truss	6.4	101.6	15.9	2.8
04-APT641270	Truss	6.4	127.0	15.9	2.8
04-APT641524	Truss	6.4	152.4	15.9	2.8

Material : Nylon White

Pop Rivets

- ★ Polly Carbonate / Nylon 6/6
- ★ Black / Natural Colour

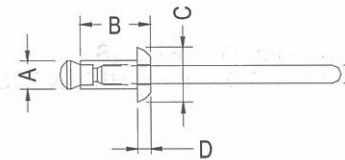
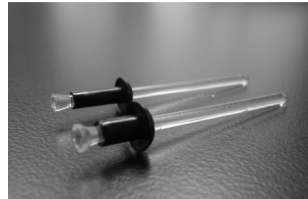

Part Number	A	B	C	D	E	Mounting Hole ϕ	Chassis Thickness	Cut Out Force
04-PPRV3350B	3.2	6.4	6.4	1.4	2.1	3.3	1.0~4.0	20
04-PPRV3382B	3.2	9.6	6.4	1.4	2.1	3.3	4.0~7.0	20
04-PPRV33113B	3.2	12.7	6.4	1.4	2.1	3.3	7.0~10.0	20
04-PPRV4146B	4.0	6.4	8.0	1.8	2.4	4.1	1.0~4.0	25
04-PPRV4178B	4.0	9.6	8.0	1.8	2.4	4.1	4.0~7.0	25
04-PPRV41109B	4.0	12.7	8.0	1.8	2.4	4.1	7.0~10.0	25
04-PPRV4860B	4.8	8.0	9.6	2.0	2.8	4.9	1.5~5.0	40
04-PPRV4892B	4.8	11.2	9.6	2.0	2.8	4.9	5.0~8.0	40
04-PPRV48124B	4.8	14.4	9.6	2.0	2.8	4.9	8.0~11.0	40
04-PPRV5774B	5.6	9.6	12.0	2.2	3.4	5.7	2.0~5.5	65
04-PPRV57105B	5.6	12.7	12.0	2.2	3.4	5.7	5.8~8.5	65
04-PPRV57137B	5.6	15.9	12.0	2.2	3.4	5.7	8.5~12.0	65
04-PPRV5516	4.7	16.5	8.9	1.8		5.5	1.5~4.5	
04-PPRV6318	6.1	17.8	16.7	2.4		6.3	3.9~5.9	
04-PPRV6328C	6.1	28.0	16.8	2.4		6.3	3.9~10.0	
04-PPRV6328D	6.1	28.0	12.9	2.4		6.3	3.9~10.0	