

Hi-Q Components

Hi-Q Electronics Ltd, PO Box 302 015, North Harbour, Auckland, New Zealand Ph + 64 9 415 3333 Fax + 64 9 415 8686

4701 - Knobs – Three Prong - Female

- ★ Available in Black Reinforced Thermoplastic
- ★ Threaded Female Brass Insert
- ★ Also available with Treated Steel Insert

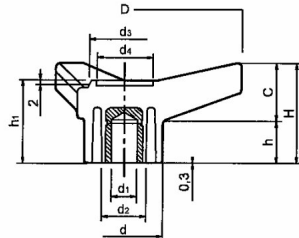

| Part Number | D | H | d1 | d2 | d3 | d | d4 | h | h1 | C |
|--------------|-----|----|-----|----|------|----|----|------|------|------|
| 11-K3P45B6 | 45 | 21 | M6 | - | 14.5 | 16 | 10 | 10 | 17.5 | 11 |
| 11-K3P65B8 | 65 | 28 | M8 | - | 21 | 22 | 15 | 12 | 23 | 16 |
| 11-K3P85B10 | 85 | 36 | M10 | 18 | 27 | 30 | 20 | 15 | 30 | 21 |
| 11-K3P105B12 | 105 | 45 | M12 | 20 | 32 | 35 | 24 | 19 | 37 | 26 |
| 11-K3P125B12 | 125 | 53 | M12 | 26 | 40 | 42 | 27 | 22.5 | 44 | 30.5 |

4701 - Knobs – Three Prong - Male

- ★ Available in Black Reinforced Thermoplastic
- ★ Treated Threaded Steel Stud

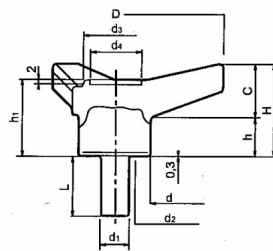

| Part Number | D | H | d1 | d3 | d | d4 | h | h1 | C | L |
|-----------------|-----|----|-----|------|----|----|------|------|------|----|
| 11-K3P45S6-25 | 45 | 21 | M6 | 14.5 | 16 | 10 | 10 | 17.5 | 11 | 25 |
| 11-K3P65S8-30 | 65 | 28 | M8 | 21 | 22 | 15 | 12 | 23 | 16 | 30 |
| 11-K3P85S10-40 | 85 | 36 | M10 | 27 | 30 | 20 | 15 | 30 | 21 | 40 |
| 11-K3P105S12-50 | 105 | 45 | M12 | 32 | 35 | 24 | 19 | 37 | 26 | 50 |
| 11-K3P125S12-50 | 125 | 53 | M12 | 40 | 42 | 27 | 22.5 | 44 | 30.5 | 50 |