

Hi-Q Components

Hi-Q Electronics Ltd, PO Box 302 015, North Harbour, Auckland, New Zealand Ph + 64 9 415 3333 Fax + 64 9 415 8686

Strain Relief Bushes

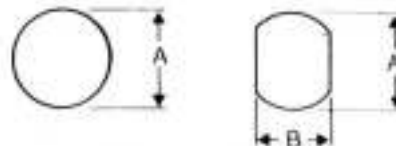
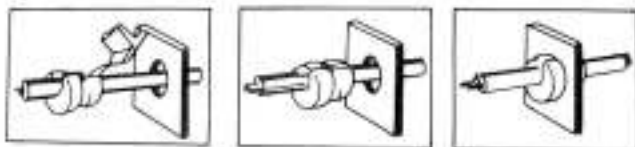

Hole dimensions

- ★ One piece design cuts assembly time.
- ★ Efficient strain relief and insulation.

Straight Entry Types

Part Number	Cable Shape	Approx. Cable Size	Hole Size		Length D	Max. Panel Thickness F
			Dia. A	Flats B		
21-MP2L1*	Flat	2.6x3.5	9.5	8.4	10.4	3.2
21-MP2P4*	Flat	2.6x5.0	9.5	8.4	10.4	1.6
21-PKF311	Flat	3.0x5.6	11.0	9.9	10.3	1.6
21-PKF312	Flat	3.0x5.6	11.0	9.9	10.3	2.5
21-PKF411	Flat	3.0x7.1	12.7	11.8	10.3	1.6
21-PKF412	Flat	3.0x7.1	12.7	11.8	10.3	2.5
21-MP4K1B*	Flat	3.8x7.4	12.7	11.7	11.7	2.5
21-PKF511	Flat	4.6x9.5	14.3	13.2	15.2	1.6
21-MP2M4B*	Round	3-4 ϕ	9.5	8.4	10.4	1.6
21-MP5N4B*	Round	5-6.5 ϕ	12.7	11.4	11.1	1.6
21-MP5P4B*	Round	5-6.5 ϕ	12.7	11.4	11.1	2.5
21-PKR511	Round	5-6.5 ϕ	12.7	11.5	11.0	1.6
21-PKR512	Round	5-6.5 ϕ	12.7	11.5	11.0	2.5
21-MP6N4B*	Round	7-8 ϕ	15.9	14.0	14.7	1.6
21-MP6P4B*	Round	7-8 ϕ	15.9	14.0	14.7	3.2
21-PKR611	Round	8.2-9.2 ϕ	15.9	14.0	14.8	1.6
21-PKR613	Round	8-9 ϕ	15.9	14.0	14.8	3.2
21-PLR623	Round	6-7 ϕ	15.9	14.0	18.0	3.2
21-PLR603	Round	8-9.5 ϕ	15.9	14.0	18.0	3.2
21-MP7P2B*	Round	9-10.5 ϕ	19.0	16.8	18.9	3.2

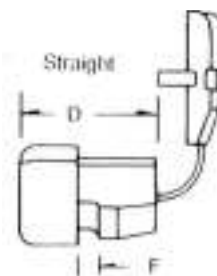

MP & PK Series Tough Nylon Bushings meet all UL & CSA stringent pull-out and temperature specifications.

Heat Stabilised Nylon Black (* available also in White) Temp. Index 105°C

Right Angle Entry Types

21-MP14LF	Flat	3.5-7.0	12.7	11.4	17.5	2.5
21-MP15LR	Round	5-6.5 ϕ	12.7	11.4	17.5	2.5

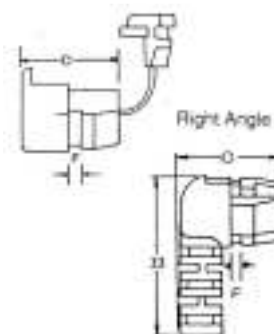

Right Angle Entry with Flexible Support

21-PK42LF	Flat	3.3x6.6	12.7	10.9	20.5	2.0
-----------	------	---------	------	------	------	-----

Assembly Tool

- ★ Unique rack and pinion principle hand tool applies precise pressure for rapid insertion without risk of damage to cable or panel.



Part No 30-TKT1

Hi-Q Components

Hi-Q Electronics Ltd, PO Box 302 015, North Harbour, Auckland, New Zealand Ph + 64 9 415 3333 Fax + 64 9 415 8686

Standard Type

- ★ Nylon fingers give even pressure on gland for good seal.
- ★ Two piece gland insert permits wide range of cable diameters.

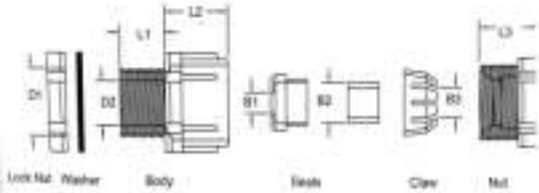

Part Number	Hole Dia. D1	D2	B2	B3	L1	L2	L3	Cable Dia. Range
23-PGA16	16	10.5	7	10	12	17	16.5	5-9
23-PGA20	20	13.7	9	13	13	19	19.5	8-13
23-PGA25	25	18.5	11	17	13	22	21.0	10-18

UL Approved Nylon 6/6 Black PG Thread Pitch 1.5mm

Strain Relief Type

- ★ Support for cable in portable situations.

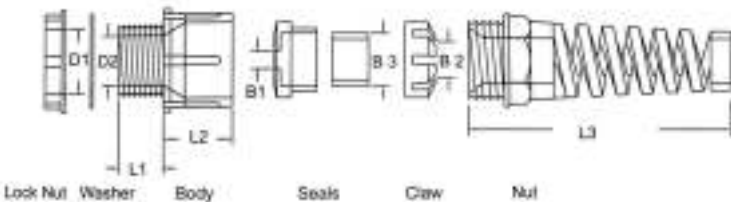

Part Number	Hole Dia. D1	D2	B2	B3	L1	L2	L3	Cable Dia. Range
23-PGA16SR	16	10.5	7	10	12	17	62	5-9
23-PGA20SR	20	13.7	9	13	13	19	78	8-13

UL Approved Nylon 6/6 Black PG Thread Pitch 1.5mm

Right Angle Cable Gland

- ★ One piece body/claw speeds up assembly.

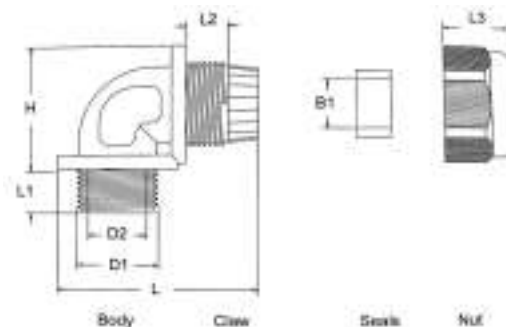

NPT Thread

Part Number	Hole Dia. D1	NPT Thread	D2	B1	L1	L2	L3	L	H	Cable Dia. Range mm
23-NPTA16	16.6	3/8"	12	9.3	11.7	9.9	16.7	48.5	30.0	5 - 9
23-NPTA21	21.0	1/2"	14	13.0	14.7	11.8	18.4	51.8	31.2	10 - 13
23-NPTA26	26.3	3/4"	19.2	16.4	14.8	12.6	22.3	64.5	41.6	13 - 16
23-NPTA42	41.7	1 1/4"	31.6	29.3	18.8	16.3	31.0	85.0	53.0	22 - 29

Hi-Q Components

Hi-Q Electronics Ltd, PO Box 302 015, North Harbour, Auckland, New Zealand Ph + 64 9 415 3333 Fax + 64 9 415 8686

Metric Integral Claw Type

- ★ One piece body/claw speeds up assembly.
- ★ UR E186042.

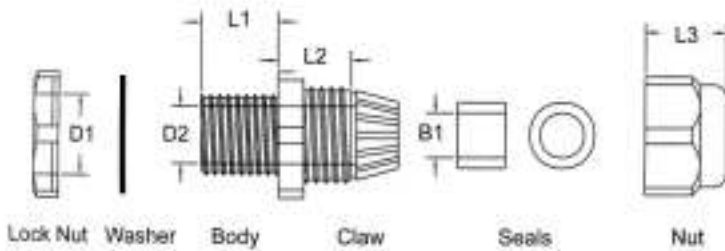

IP68



Metric Thread UL Approved Nylon 6/6 94V-2 Black

Part Number	Hole Dia. D1	D2	B1	L1	L2	L3	Cable Dia. Range mm
23-MAG12	12	8.3	6.0	7.9	12.1	13.3	3-6.5
23-MAG16	16	10.9	9.6	15.7	14.4	16.7	5-10
23-MAG20	20	14.8	12.9	15.0	19.5	18.4	10-14
23-MAG25	25	18.6	16.4	15.0	18.7	22.3	13-18

Metric Strain Relief Type

- ★ One piece body/claw speeds up assembly.

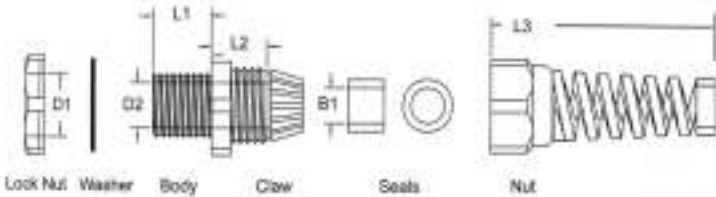

IP68



Metric Thread UL Approved Nylon 6/6 94V-2 Black

Part Number	Hole Dia. D1	D2	B1	L1	L2	L3	Cable Dia. Range mm
23-MAG12SR	12	8.3	6.0	7.9	12.1	53.3	3-6.5
23-MAG16SR	16	10.9	9.6	14.4	14.4	74.9	5-10
23-MAG20SR	20	14.8	12.9	12.8	19.5	96.2	10-14
23-MAG25SR	25	18.6	16.5	13.9	19.5	111.2	13-18

Metric Reduction Fittings

- ★ Switch from large metric gland to small one.
- ★ Thread Length 8mm.

Part Number	D1	D2
23-M2012	M20	M12
23-M2016	M20	M16
23-M2516	M25	M16
23-M2520	M25	M20



Material :

UL Approved Nylon 6/6 94V-2 Black

Metric Screw Plugs



Part No.	A	B	C	D
22-MSP12	M12	15.0	10.0	6.0
22-MSP16	M16	20.0	10.5	6.0
22-MSP20	M20	24.0	10.5	6.0
22-MSP25	M25	29.7	12.8	7.8
22-MSP32	M32	36.6	13.3	7.8
22-MSP40	M40	45.8	13.4	7.8
22-MSP50	M50	55.5	16.2	9.8