

Rivets - Post Type

- ★ The self expanding principle assures firm grip even under constant vibration
- ★ Permits application from one side only for blind applications
- ★ Tools to use range from small hammer or hand tools (TRT1/TRT2) to custom made pneumatic tools

Installation Set

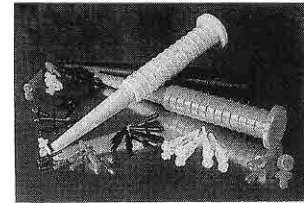
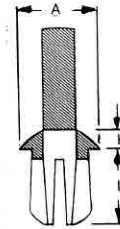
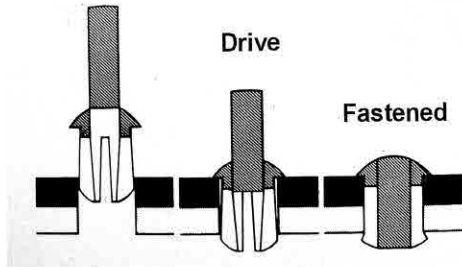

Insertion Tools

| Part Number | Rivet Pin Dia. | Colour | Suitable for Rivets |
|-------------|----------------|--------|---------------------|
| 30-TRT1 | 1.91 | Red | PRT34/40 |
| 30-TRT2 | 3.18 | Yellow | PRT48 |
| 30-TRT3 | 3.81 | Green | PRT64/68 |

| Part Number | Nominal Hole Dia. | Panel Thickness | A | H | L | Pin Dia | Colour |
|-------------|-------------------|-----------------|------|-----|------|---------|---------|
| 04-PPRT34N | 3.2 | 0.8-3.6 | 4.8 | 1.2 | 4.8 | 1.9 | Natural |
| 04-PPRT40N | 4.0 | 4.8-6.4 | 5.5 | 1.3 | 7.9 | 2.4 | Natural |
| 04-PPRT41AN | 4.1 | 1.6-4.6 | 7.5 | 1.3 | 5.8 | 2.4 | Natural |
| 04-PPRT48AN | 4.8 | 1.6-4.8 | 7.1 | 1.9 | 7.5 | 3.2 | Natural |
| 04-PPRT48BN | 4.8 | 2.0-9.5 | 7.1 | 1.2 | 11.4 | 3.2 | Natural |
| 04-PPRT48CN | 4.8 | 7.9-11.2 | 7.1 | 1.9 | 13.6 | 3.2 | Natural |
| 04-PPRT64BN | 6.4 | 2.4-7.9 | 11.9 | 2.0 | 12.7 | 3.8 | Natural |
| 04-PPRT68N | 6.8 | 2.4-4.8 | 15.8 | 2.8 | 7.6 | 3.8 | Natural |

Other non stock sizes available on short delivery - Black also available in all sizes.

Screw Rivets

- ★ 2 piece combination screw and rivet
- ★ Push screw to snap tight, unscrew to loosen

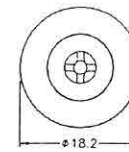
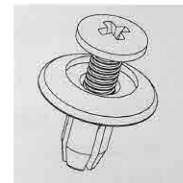
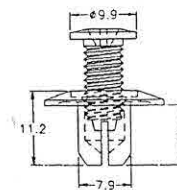
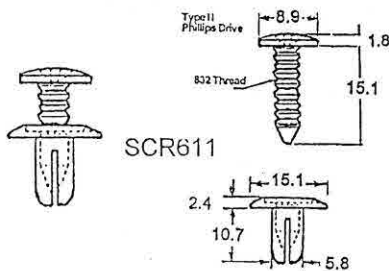

SCR809

| Part Number | Hole Dia.mm | Panel Thickness mm | Length L | Head Dia. A | Hd Height H |
|-------------|-------------|--------------------|----------|-------------|-------------|
| 04-SCR611 | 6.1-6.4 | 3.2 - 6.4 | 10.7 | 15.1 | 3.0 |
| 04-SCR711B | 6.9-7.2 | 1.6 - 3.2 | 11.1 | 14.2 | 3.0 |
| 04-SCR809 | 8.0-8.2 | 2.5 - 5.0 | 9.0 | 18.2 | 3.0 |

Snap Rivets - Pan Head

- ★ Ready assembled 2 part rivet★ Fast economical assembly to lock panels
- ★ Permits application from one side for blind applications

| Part Number | Shaft Dia | Panel Thickness | Length L | Head Dia. A | Hd Height H |
|-------------|-----------|-----------------|----------|-------------|-------------|
| 04-PRT2060B | 2.0 | 3.5-4.5 | 6.0 | 4.8 | 0.75 |
| 04-PRT2642B | 2.6 | 2.0-3.0 | 4.2 | 5.0 | 1.4 |
| 04-PRT2648B | 2.6 | 2.5-3.4 | 4.8 | 5.0 | 1.4 |
| 04-PRT2655B | 2.6 | 3.0-4.3 | 5.5 | 5.0 | 1.4 |
| 04-PRT3035B | 3.0 | 1.3-2.5 | 3.5 | 6.3 | 1.5 |
| 04-PRT3055B | 3.0 | 3.0-4.0 | 5.5 | 6.3 | 1.5 |
| 04-PRT3065B | 3.0 | 4.0-5.0 | 6.5 | 6.2 | 1.6 |
| 04-PRT3075B | 3.0 | 5.0-6.0 | 7.5 | 6.2 | 1.6 |
| 04-PRT3090B | 3.0 | 6.5-7.5 | 9.1 | 6.3 | 1.7 |
| 04-PRT3100B | 3.0 | 7.5-8.5 | 10.0 | 6.2 | 1.6 |
| 04-PRT3130B | 3.0 | 10.2-11.2 | 13.2 | 6.3 | 1.5 |
| 04-PRT3550B | 3.5 | 3.0-4.0 | 5.5 | 6.3 | 1.7 |
| 04-PRT4050B | 4.0 | 2.5-3.5 | 5.0 | 8.0 | 1.8 |
| 04-PRT4059B | 3.9 | 1.2-4.5 | 5.9 | 8.0 | 1.8 |
| 04-PRT4060B | 4.0 | 3.5-4.5 | 6.0 | 8.0 | 1.8 |
| 04-PRT4080B | 4.0 | 2.5-6.4 | 8.0 | 7.0 | 1.8 |
| 04-PRT4100B | 4.0 | 7.5-8.5 | 10.0 | 8.0 | 2.0 |
| 04-PRT4120B | 4.0 | 9.5-10.5 | 12.0 | 8.0 | 2.0 |
| 04-PRT4250B | 4.0 | 19-20.5 | 25.0 | 8.0 | 2.0 |
| 04-PRT5045B | 5.0 | 1.5-2.5 | 4.5 | 8.8 | 2.2 |
| 04-PRT5055B | 5.0 | 2.5-3.5 | 5.5 | 8.8 | 2.2 |
| 04-PRT5065B | 5.0 | 3.5-4.5 | 6.5 | 8.8 | 2.2 |
| 04-PRT5070B | 5.0 | 4.0-5.0 | 7.0 | 9.0 | 1.5 |
| 04-PRT5090B | 5.0 | 5.8-7.6 | 9.4 | 9.0 | 1.5 |
| 04-PRT5110B | 4.9 | 7.5-8.5 | 10.4 | 8.9 | 2.2 |
| 04-PRT6060B | 6.0 | 3.0-4.0 | 6.0 | 8.8 | 2.2 |

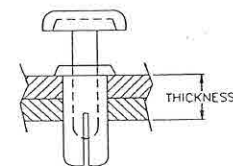
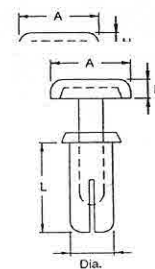
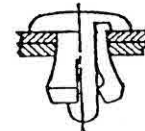

Nylon 6/6 Black (Suffix 'B'.) White and Natural available in some sizes (Suffix 'W' or 'N').
Other non stock sizes available.

Ratchet Rivets

Large head option,
Strong connection,
Suitable for soft materials

- ★ Identical nylon fasteners pressed together to close. Use two per connection

| Part Number | Hole Dia | Panel Thickness | Length L | Head Dia. D | Head Height |
|-------------|----------|-----------------|----------|-------------|-------------|
| 04-PRR70609 | 6.4 | 6.0-7.5 | 5.5 | 9.5 | 1.0 |
| 04-PRR70610 | 7.1 | 6.0-7.5 | 5.5 | 10.3 | 1.0 |
| 04-PRR70619 | 7.1 | 6.0-7.5 | 5.5 | 19.1 | 2.0 |
| 04-PRR70810 | 7.1 | 8.8-12.7 | 8.7 | 10.3 | 1.0 |
| 04-PRR70819 | 7.1 | 8.8-12.7 | 8.7 | 19.1 | 2.0 |
| 04-PRR71319 | 7.1 | 12.7-20.6 | 12.7 | 19.1 | 2.0 |
| 04-PRR71919 | 7.1 | 19.8-34.9 | 19.1 | 19.1 | 2.0 |

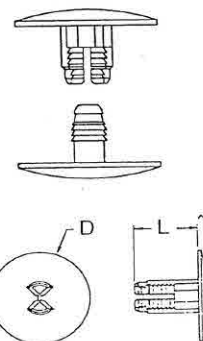

Mini Rivets

- ★ Mini Rivets press together for quick fastening
- ★ Male and Female parts are packaged and sold separately

| Part Number | Description | Post Dia | Panel Thickness | Dia. A | Thick. B |
|-------------|-------------|----------|-----------------|--------|----------|
| 04-PMRM320 | Male | 3.2 | 1.6 | 12.7 | 2.5 |
| 04-PMRM324 | Male | 3.2 | 2.4 | 12.7 | 2.5 |
| 04-PMRM332 | Male | 3.2 | 3.2 | 12.7 | 2.5 |
| 04-PMRM348 | Male | 3.2 | 4.8 | 12.7 | 2.5 |
| 04-PMRM3479 | Adj. Male | 3.12 | 3.2-47.9 | 12.7 | 1.6 |
| 04-PMRF3 | Female | 3.2 | N/A | 12.7 | 2.5 |

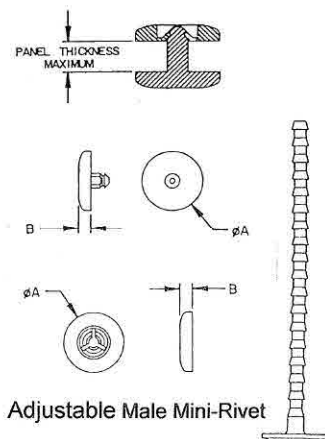

Panel Latch

- ★ Ideal for inspection panels or door latches
- ★ Fast economical assembly to lock panel in place. Supplied in two parts, the pin is fitted to the grommet through a hole in the opening panel, then the grommet is inserted into the hole in the fixed panel
- ★ A simple push pull is all that is required to close or open the panel

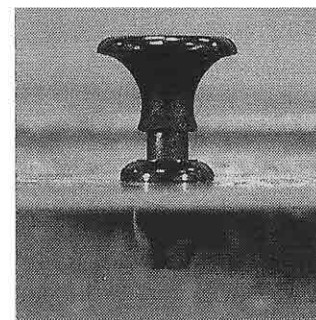
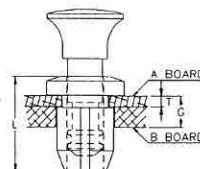
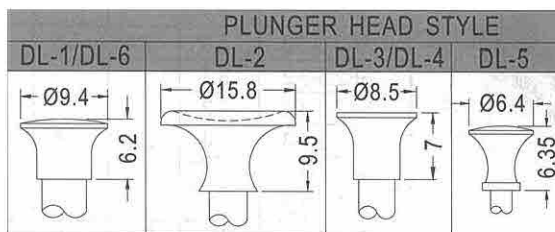

| Part Number | Hole Diameter | | Grommet Length L | Knob Dia. | Knob Style | A Panel Thickness A | Overall Thickness H |
|-------------|---------------|-------------|------------------|-----------|------------|---------------------|---------------------|
| | A Panel Dia | B Panel Dia | | | | | |
| 04-PDL1 | 7.5 | 8.0 | 11.1 | 9.4 | DL-1 | 1.6 | 2.0 ~ 4.2 |
| 04-PDL2 | 7.5 | 8.0 | 11.2 | 16.0 | DL-2 | 1.6 | 2.0 ~ 4.2 |
| 04-PDL3 | 6.0 ~ 6.1 | 6.3 ~ 6.5 | 10.4 | 8.5 | DL-3 | 1.6 | 2.0 ~ 4.2 |
| 04-PDL4 | 6.0 ~ 6.1 | 6.3 ~ 6.5 | 11.4 | 8.5 | DL-4 | 2.5 | 3.0 ~ 5.2 |
| 04-PDL5 | 4.5 | 4.8 | 9.5 | 6.4 | DL-5 | 1.6 | 2.0 ~ 3.6 |

Nylon 6/6 Black

Anchor Rivets

- ★ Anchor Rivets provide versatile, inexpensive, corrosion & vibration resistant blind fasteners for solid or hollow materials including wood, concrete, plaster, metal or plastic
- ★ Installation is fast, rivet is inserted in predrilled hole and tapped with a hammer
The drive pin expands and secures the rivet
- ★ Typical uses include signs, liner panels, rails, floor plates, electrical and plumbing fixtures, conduit and piping

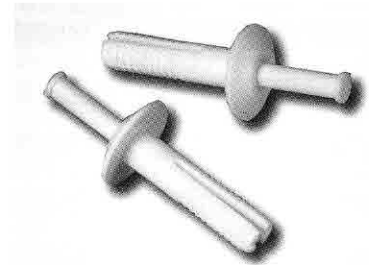
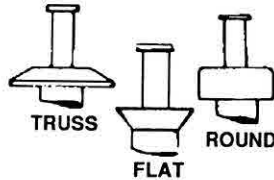
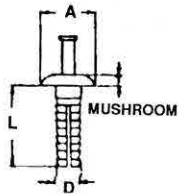

Also available with
Zinc Plated Steel Drive Pin.

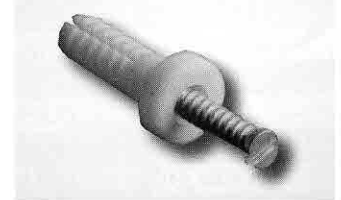

| Part Number | Head Style | Shaft Dia. D | Length L | Head Dia. A | Head Height |
|--------------|---------------|--------------|----------|-------------|-------------|
| 04-APM48191 | Mushroom | 4.8 | 19.1 | 14.3 | 2.8 |
| 04-APM64191 | Mushroom | 6.4 | 19.1 | 14.3 | 2.8 |
| 04-APM64254 | Mushroom | 6.4 | 25.4 | 14.3 | 2.8 |
| 04-APM64381 | Mushroom | 6.4 | 38.1 | 14.3 | 2.8 |
| 04-APF64143 | C/sink / Flat | 6.4 | 14.3 | 11.1 | 2.7 |
| 04-APF64191 | C/sink / Flat | 6.4 | 19.1 | 11.1 | 2.7 |
| 04-APT48191 | Truss | 4.8 | 19.1 | 15.9 | 2.8 |
| 04-APT64191 | Truss | 6.4 | 19.1 | 15.9 | 2.8 |
| 04-APT64254 | Truss | 6.4 | 25.4 | 15.9 | 2.8 |
| 04-APT64381 | Truss | 6.4 | 38.1 | 15.9 | 2.8 |
| 04-APT64508 | Truss | 6.4 | 50.8 | 15.9 | 2.8 |
| 04-APT64762 | Truss | 6.4 | 76.2 | 15.9 | 2.8 |
| 04-APT641016 | Truss | 6.4 | 101.6 | 15.9 | 2.8 |
| 04-APT641270 | Truss | 6.4 | 127.0 | 15.9 | 2.8 |
| 04-APT641524 | Truss | 6.4 | 152.4 | 15.9 | 2.8 |

Material : Nylon White

Pop Rivets

- ★ Polly Carbonate / Nylon 6/6
- ★ Black / Natural Colour

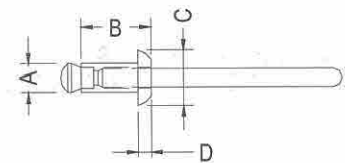

| Part Number | A | B | C | D | E | Mounting Hole ϕ | Chassis Thickness | Cut Out Force |
|---------------|-----|------|------|-----|-----|----------------------|-------------------|---------------|
| 04-PPRV3350B | 3.2 | 6.4 | 6.4 | 1.4 | 2.1 | 3.3 | 1.0~4.0 | 20 |
| 04-PPRV3382B | 3.2 | 9.6 | 6.4 | 1.4 | 2.1 | 3.3 | 4.0~7.0 | 20 |
| 04-PPRV33113B | 3.2 | 12.7 | 6.4 | 1.4 | 2.1 | 3.3 | 7.0~10.0 | 20 |
| 04-PPRV4146B | 4.0 | 6.4 | 8.0 | 1.8 | 2.4 | 4.1 | 1.0~4.0 | 25 |
| 04-PPRV4178B | 4.0 | 9.6 | 8.0 | 1.8 | 2.4 | 4.1 | 4.0~7.0 | 25 |
| 04-PPRV41109B | 4.0 | 12.7 | 8.0 | 1.8 | 2.4 | 4.1 | 7.0~10.0 | 25 |
| 04-PPRV4860B | 4.8 | 8.0 | 9.6 | 2.0 | 2.8 | 4.9 | 1.5~5.0 | 40 |
| 04-PPRV4892B | 4.8 | 11.2 | 9.6 | 2.0 | 2.8 | 4.9 | 5.0~8.0 | 40 |
| 04-PPRV48124B | 4.8 | 14.4 | 9.6 | 2.0 | 2.8 | 4.9 | 8.0~11.0 | 40 |
| 04-PPRV5774B | 5.6 | 9.6 | 12.0 | 2.2 | 3.4 | 5.7 | 2.0~5.5 | 65 |
| 04-PPRV57105B | 5.6 | 12.7 | 12.0 | 2.2 | 3.4 | 5.7 | 5.8~8.5 | 65 |
| 04-PPRV57137B | 5.6 | 15.9 | 12.0 | 2.2 | 3.4 | 5.7 | 8.5~12.0 | 65 |
| 04-PPRV5516 | 4.7 | 16.5 | 8.9 | 1.8 | | 5.5 | 1.5~4.5 | |
| 04-PPRV6318 | 6.1 | 17.8 | 16.7 | 2.4 | | 6.3 | 3.9~5.9 | |
| 04-PPRV6328C | 6.1 | 28.0 | 16.8 | 2.4 | | 6.3 | 3.9~10.0 | |
| 04-PPRV6328D | 6.1 | 28.0 | 12.9 | 2.4 | | 6.3 | 3.9~10.0 | |

Arrow Clips

- ★ The body is designed to compress as it is forced through a prepunched hole and spring back to its original shape to lock assembled parts securely
- ★ Corrosion resistant

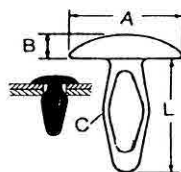

| Part Number | Hole Diameter | Panel Thickness | Length L | Head Dia. A | Head Height B | Dim. C |
|-------------|---------------|-----------------|----------|-------------|---------------|--------|
| 04-PCC022 | 2.2-2.3 | 0.8-2.7 | 4.8 | 3.2 | 0.8 | 2.7 |
| 04-PCC030 | 3.0-3.1 | 1.6-3.2 | 9.9 | 7.1 | 1.5 | 3.7 |
| 04-PCC035 | 3.3-3.5 | 2.0-3.1 | 8.6 | 7.5 | 1.5 | 4.0 |
| 04-PCC036 | 3.3-3.6 | 3.0-4.0 | 10.8 | 7.5 | 1.5 | 3.8 |
| 04-PCC003 | 3.8-4.1 | 1.6-3.2 | 9.9 | 7.1 | 1.0 | 5.0 |
| 04-PCC004 | 3.8-4.1 | 1.6-3.7 | 10.2 | 7.1 | 2.0 | 4.6 |
| 04-PCC049 | 4.6-4.9 | 1.6-3.2 | 10.2 | 9.1 | 1.5 | 5.7 |
| 04-PCC057 | 5.4-5.7 | 1.6-3.2 | 11.4 | 9.4 | 1.5 | 5.7 |
| 04-PCC065 | 6.0-6.5 | 3.2-4.8 | 14.6 | 12.3 | 1.5 | 7.4 |
| 04-PCC085 | 8.4-8.5 | 1.6-8.6 | 22.9 | 17.4 | 1.8 | 9.5 |

Nylon 6/6 Natural - Other non stock sizes available.

Keyhole Clips

- ★ Multi-purpose fastener clip
- ★ Easy assembly with finger pressure
- ★ Angled panel lock section takes up slack in panels

| Part Number | Head Diam. 'H' | Hole Size | Panel Thickness |
|-------------|----------------|-----------|-----------------|
| 04-PKY3024 | 6.3 | 3.2 | 2.4 |
| 04-PKY3032 | 6.3 | 3.2 | 3.2 |
| 04-PKY3040 | 6.3 | 3.2 | 4.0 |
| 04-PKY4024 | 8.0 | 4.0 | 2.4 |
| 04-PKY4032 | 8.0 | 4.0 | 3.2 |
| 04-PKY4040 | 8.0 | 4.0 | 4.0 |
| 04-PKY4048 | 8.0 | 4.0 | 4.8 |
| 04-PKY5024 | 8.0 | 4.8 | 2.4 |
| 04-PKY5032 | 8.0 | 4.8 | 3.2 |
| 04-PKY5040 | 8.0 | 4.8 | 4.0 |
| 04-PKY5048 | 8.0 | 4.8 | 4.8 |
| 04-PKY5056 | 8.0 | 4.8 | 5.6 |
| 04-PKY5063 | 8.0 | 4.8 | 6.3 |
| 04-PKY5080 | 8.0 | 4.8 | 8.0 |
| 04-PKY5095 | 8.0 | 4.8 | 9.5 |
| 04-PKY6024 | 12.7 | 6.3 | 2.4 |
| 04-PKY6032 | 12.7 | 6.3 | 3.2 |
| 04-PKY6040 | 12.7 | 6.3 | 4.0 |
| 04-PKY6048 | 12.7 | 6.3 | 4.8 |
| 04-PKY6063 | 12.7 | 6.3 | 6.3 |
| 04-PKY6071 | 12.7 | 6.3 | 7.1 |
| 04-PKY6080 | 12.7 | 6.3 | 8.0 |
| 04-PKY6095 | 12.7 | 6.3 | 9.5 |
| 04-PKY6127 | 12.7 | 6.3 | 12.7 |

Nylon 6/6

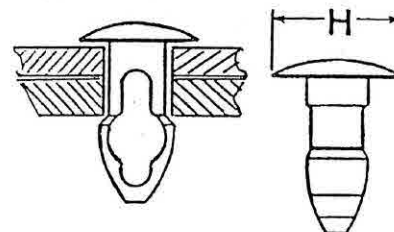
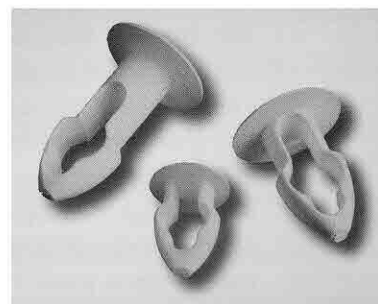

Push in Fastener

- ★ A fast, convenient method to join insulating materials, light sheet metal, circuit board material
- ★ Special designed legs provide compression and expansion to lock fastener into pre-punched holes

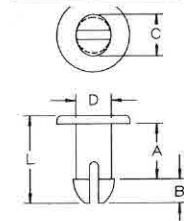

| Part Number | Nominal Hole | H | A | B | C | D | L |
|-------------|--------------|------|------|-----|-----|-----|------|
| 04-PIF236 | 2.5 | 4.8 | 1.7 | 1.9 | 2.5 | 2.3 | 4.6 |
| 04-PIF347 | 3.0 | 5.2 | 3.1 | 2.7 | 3.7 | 2.9 | 6.6 |
| 04-PIF343 | 3.0 | 5.2 | 4.0 | 3.4 | 3.6 | 2.9 | 8.2 |
| 04-PIF346 | 3.0 | 5.2 | 6.4 | 2.7 | 3.7 | 2.9 | 10.0 |
| 04-PIF450 | 4.3 | 8.7 | 3.2 | 3.5 | 5.1 | 4.2 | 7.5 |
| 04-PIF481 | 4.3 | 8.7 | 3.2 | 3.5 | 5.1 | 4.2 | 7.9 |
| 04-PIF537 | 4.8 | 9.5 | 16.2 | 4.6 | 5.6 | 4.6 | 22.2 |
| 04-PIF553 | 4.8 | 8.7 | 6.1 | 4.4 | 5.7 | 4.5 | 12.5 |
| 04-PIF628 | 6.2 | 8.7 | 22.2 | 4.4 | 5.7 | 4.5 | 28.3 |
| 04-PIF666 | 6.1 | 11.5 | 8.4 | 4.8 | 7.5 | 6.1 | 14.1 |
| 04-PIF763 | 6.5 | 11.5 | 7.0 | 3.6 | 7.5 | 6.1 | 11.7 |
| 04-PIF765 | 6.5 | 15.1 | 12.2 | 4.7 | 7.4 | 6.2 | 18.2 |

Nylon - Other non stock sizes available.

Snap Clips

- ★ A combination of tough acetal and a resilient design give these clips a positive snap and more definite grip when assembled

| Part Number | Hole Size | Panel Thickness | Head Diam. D | Length B | Hd Height A |
|-------------|-----------|-----------------|--------------|----------|-------------|
| 04-PSN3008 | 3.2 | 0.8 | 6.3 | 6.3 | 1.5 |
| 04-PSN3016 | 3.2 | 1.6 | 6.3 | 7.1 | 1.5 |
| 04-PSN3024 | 3.2 | 2.4 | 6.3 | 7.9 | 1.5 |
| 04-PSN3032 | 3.2 | 3.2 | 6.3 | 8.7 | 1.5 |
| 04-PSN4008 | 4.0 | 0.8 | 8.0 | 7.1 | 1.5 |
| 04-PSN4016 | 4.0 | 1.6 | 8.0 | 7.9 | 1.5 |
| 04-PSN4024 | 4.0 | 2.4 | 8.0 | 8.7 | 1.5 |
| 04-PSN4032 | 4.0 | 3.2 | 8.0 | 9.5 | 1.5 |
| 04-PSN4040 | 4.0 | 4.0 | 8.0 | 10.3 | 1.5 |
| 04-PSN5008 | 4.8 | 0.8 | 8.0 | 7.9 | 1.5 |
| 04-PSN5016 | 4.8 | 1.6 | 8.0 | 8.7 | 1.5 |
| 04-PSN5024 | 4.8 | 2.4 | 8.0 | 9.5 | 1.5 |
| 04-PSN5032 | 4.8 | 3.2 | 8.0 | 10.3 | 1.5 |
| 04-PSN5040 | 4.8 | 4.0 | 8.0 | 11.1 | 1.5 |
| 04-PSN6016 | 6.3 | 1.6 | 12.7 | 10.7 | 1.5 |
| 04-PSN6024 | 6.3 | 2.4 | 12.7 | 11.5 | 1.5 |
| 04-PSN6032 | 6.3 | 3.2 | 12.7 | 12.3 | 1.5 |
| 04-PSN6040 | 6.3 | 4.0 | 12.7 | 13.1 | 1.5 |
| 04-PSN6048 | 6.3 | 4.8 | 12.7 | 13.9 | 1.5 |

Material: Acetal Natural (Off white)

