

Plastic Line | Steel

Black Polyamide Plastic Base 50 Diameter - 30 Deg. Articulated Steel Screw

Static Load Newton 10000 • 15 Socket • Non-Skid NBR Rubber 70 shore pads available

Part no. Base	Part no. Screw	Screw	S	B	D	Adjust	F	G	H
11-FBP15-50	11-ASSS15-10-050	M10X50	30	50	50	14	M10	20	80
11-FBP15-50	11-ASSS15-10-100	M10X100	30	100	50	14	M10	20	130
11-FBP15-50	11-ASSS15-10-125	M10X125	30	125	50	14	M10	20	155
11-FBP15-50	11-ASSS15-12-075	M12X75	30	75	50	14	M12	20	105
11-FBP15-50	11-ASSS15-12-100	M12X100	30	100	50	14	M12	20	130
11-FBP15-50	11-ASSS15-12-125	M12X125	30	125	50	14	M12	20	155
11-FBP15-50	11-ASSS15-12-150	M12X150	30	150	50	14	M12	20	180

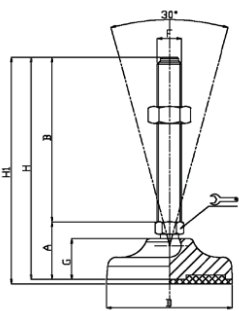

Two piece part

Black Polyamide Plastic Base 65 Diameter - 30 Deg. Articulated Steel Screw

Static Load Newton 11000 • 15 Socket • Non-Skid NBR Rubber 70 shore pads available

Part no. Base	Part no. Screw	Screw	S	B	D	Adjust	F	G	H
11-FBP15-65	11-ASS15-10-050	M10X50	33	50	65	14	M10	23	83
11-FBP15-65	11-ASS15-10-100	M10X100	33	100	65	14	M10	23	133
11-FBP15-65	11-ASS15-10-125	M10X125	33	125	65	14	M10	23	158
11-FBP15-65	11-ASS15-12-075	M12X75	33	75	65	14	M12	23	108
11-FBP15-65	11-ASS15-12-100	M12X100	33	100	65	14	M12	23	133
11-FBP15-65	11-ASS15-12-125	M12X150	33	150	65	14	M12	23	183
11-FBP15-65	11-ASS15-16-075	M16X75	33	75	65	16	M16	23	108
11-FBP15-65	11-ASS15-16-100	M16X100	33	100	65	16	M16	23	133
11-FBP15-65	11-ASS15-16-125	M16X125	33	125	65	16	M16	23	158
11-FBP15-65	11-ASS15-16-150	M16X150	33	150	65	16	M16	23	183
11-FBP15-65	11-ASS15-16-175	M16X175	33	175	65	16	M16	23	208

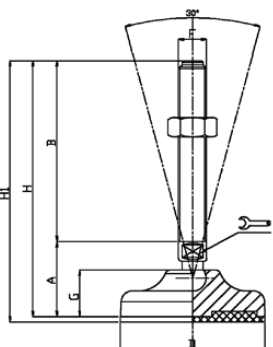

Two piece part