

3323 - Knobs – Aluminium Star - Female

Available in Aluminium polished or not polished

• These have no predrilled thread leaving thread Dia. option open

Part Number	D	H	d1
11-KAD5U40	40	26	14
11-KAD5P40	40	26	14
11-KAD5U50	50	34	18
11-KAD5P50	50	34	18
11-KAD5U63	63	42	20
11-KAD5P63	63	42	20
11-KAD5U80	80	52	25
11-KAD5P80	80	52	25

*P = Polished * U = Not Polished

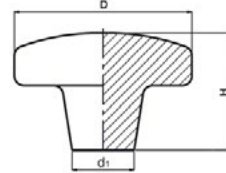

3707 Knobs -Stainless Steel

Stainless Steel

• Threaded open insert

Part Number	D	H	D1	D6	d	h3
11-KSS32T60	32	20	12	6.4	M6	10

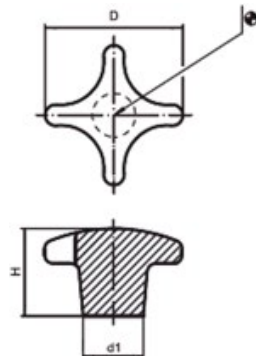

3711 - Knobs – Solid Stainless Steel - Female

Stainless Steel 1.4305

• For all applications having high hygienic requirements

Part Number	d	D	H	d1	e	h2
11-KSSS40T6	M6	40	30.5	18	12	15
11-KSSS40T8	M8	40	30.5	18	12	15
11-KSSS50T10	M10	50	34	21	15	18
11-KSSS60T12	M12	60	39	25	18	18

